



さし込み溶接形異径ティー  
 SOCKET-WELDING REDUCING TEES

**SWTR**  
 (RED. TEES)

ステンレス用  
 FOR STAINLESS STEEL

JIS B2316

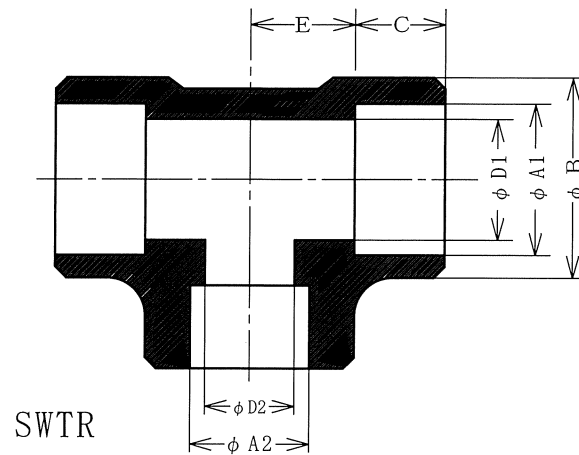

UNIT : mm

NOM. SIZE		Sch 80							
(A)	(B)	B	A <sub>1</sub>	A <sub>2</sub>	D <sub>1</sub>	D <sub>2</sub>	E	C	
① ②	① ②								
10 × 08	3/8 × 1/4	27.0	17.8	14.3	12.7	9.4	13.5	12.0	
15 × 08	1/2 × 1/4	34.0	22.2	14.3	16.1	9.4	15.9	13.0	
15 × 10	1/2 × 3/8	34.0	22.2	17.8	16.1	12.7	15.9	13.0	
20 × 08	3/4 × 1/4	39.0	27.7	14.3	21.4	9.4	19.1	14.0	
20 × 10	3/4 × 3/8	39.0	27.7	17.8	21.4	12.7	19.1	14.0	
20 × 15	3/4 × 1/2	39.0	27.7	22.2	21.4	16.1	19.1	14.0	
25 × 10	1 × 3/8	47.0	34.5	17.8	27.2	12.7	22.2	16.0	
25 × 15	1 × 1/2	47.0	34.5	22.2	27.2	16.1	22.2	16.0	
25 × 20	1 × 3/4	47.0	34.5	27.7	27.2	21.4	22.2	16.0	
32 × 15	1-1/4 × 1/2	56.0	43.2	22.2	35.5	16.1	27.0	18.0	
32 × 20	1-1/4 × 3/4	56.0	43.2	27.7	35.5	21.4	27.0	18.0	
32 × 25	1-1/4 × 1	56.0	43.2	34.5	35.5	27.2	27.0	18.0	
40 × 15	1-1/2 × 1/2	63.0	49.1	22.2	41.2	16.1	31.8	19.0	
40 × 20	1-1/2 × 3/4	63.0	49.1	27.7	41.2	21.4	31.8	19.0	
40 × 25	1-1/2 × 1	63.0	49.1	34.5	41.2	27.2	31.8	19.0	
40 × 32	1-1/2 × 1-1/4	63.0	49.1	43.2	41.2	35.5	31.8	19.0	
50 × 15	2 × 1/2	76.0	61.1	22.2	52.7	16.1	38.1	22.0	
50 × 20	2 × 3/4	76.0	61.1	27.7	52.7	21.4	38.1	22.0	
50 × 25	2 × 1	76.0	61.1	34.5	52.7	27.2	38.1	22.0	
50 × 32	2 × 1-1/4	76.0	61.1	43.2	52.7	35.5	38.1	22.0	
50 × 40	2 × 1-1/2	76.0	61.1	49.1	52.7	41.2	38.1	22.0	

特註：異径チーz-C, Eは大径側に等しく、  
 原則としてDは各々のサイズに対応する。

REMARK: RED. TEE-C, E IS EQUAL TO LARGER SIZE  
 AND D, IS CORRESPONDING TO EACH IN PRINCIPLE.

ヤマト特殊鋼株式会社  
 YAMATO SPECIAL STEEL CO., LTD.

Sheet No. JSW-12

平成22年1月5更新